

# Construction Phase 1B Diagram

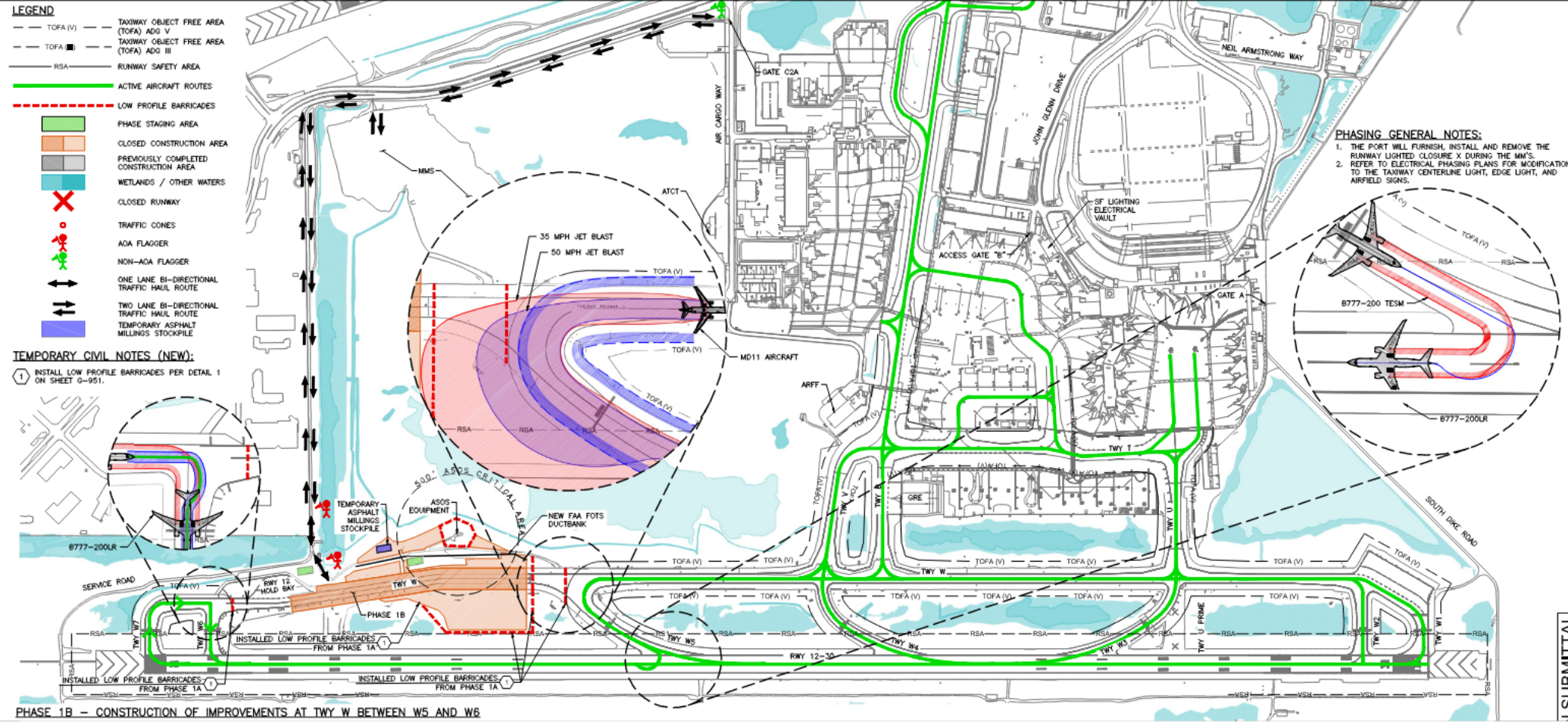

**TEMPORARY CIVIL NOTES (NEW):**  
 1. INSTALL LOW PROFILE BARRICADES PER DETAIL 1 ON SHEET G-951.

**PHASING GENERAL NOTES:**  
 1. THE PORT WILL FURNISH, INSTALL AND REMOVE THE RUNWAY LIGHTED CLOSURE X DURING THE MM'S.  
 2. REFER TO ELECTRICAL PHASING PLANS FOR MODIFICATIONS TO THE TAXIWAY CENTERLINE LIGHT, EDGE LIGHT, AND AIRFIELD SIGNS.

PHASE 1B - CONSTRUCTION OF IMPROVEMENTS AT TWY W BETWEEN W5 AND W6

SUBMITTAL